

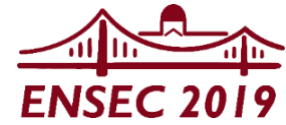

elte | ppk
Eötvös Loránd University
Faculty of Education and Psychology



7TH ENSEC CONFERENCE

Well-being and Social, Emotional Development

ELTE Eötvös Loránd University
Faculty of Education and Psychology

Budapest, August 29–31, 2019

2019

The Scientific Committee

<i>Dr. Valeria Cavioni</i>	University of Milano-Bicocca (Italy)
<i>Prof. Carmel Cefai</i>	University of Malta (Malta)
<i>Dr. Aurora Adina Colomeischi</i>	Stefan cel Mare University Suceava (Romania)
<i>Prof. Zsolt Demetrovics</i>	ELTE Eötvös Loránd University (Hungary)
<i>Prof. Knut K. Gundersen</i>	Vid Pedagogical University College (Norway)
<i>Dr. Birgitta Kimber</i>	Umeå University (Sweden)
<i>Dr. Annalisa Morganti</i>	University of Perugia (Italy)
<i>Prof. Attila Oláh</i>	ELTE Eötvös Loránd University (Hungary)
<i>Prof. Anikó Zsolnai</i>	ELTE Eötvös Loránd University (Hungary)

The Organizing Committee

<i>Anna Alexandrov</i>	ELTE Eötvös Loránd University
<i>Dr. Enikő Orsolya Bereczki</i>	ELTE Eötvös Loránd University
<i>Edit Bíró</i>	Pro Psychologia Foundation
<i>Kinga Csányi</i>	ELTE Eötvös Loránd University
<i>Dr. Anikó Fehérvári</i>	ELTE Eötvös Loránd University
<i>Tamás Kovács</i>	ELTE Eötvös Loránd University
<i>Dr. Attila Rausch</i>	ELTE Eötvös Loránd University
<i>Lilla Szabó</i>	ELTE Eötvös Loránd University
<i>Prof. Anikó Zsolnai</i>	ELTE Eötvös Loránd University

Information of Proceedings

Editors of Proceedings

Prof. Anikó Zsolnai

Dr. Attila Rausch

Technical editing of Proceedings

Edit Börcsökné Soós

TABLE OF CONTENTS

Conference Information	4
General Information	8

PROGRAM

<i>August 29</i>	9
<i>August 30</i>	15
<i>August 31</i>	19
List of Participants.....	22

WELCOME

Welcome to the 7th ENSEC Conference “Well-being and Social, Emotional Development” hosted by the Faculty of Education and Psychology of the Eötvös Loránd University (ELTE) in Budapest.

This booklet provides information about the conference and the related scientific and social activities. You can also find all information on the conference website: ensec2019.elte.hu

CONFERENCE VENUE

The primary site of the conference is the Kazinczy building (**KAZY**) of the Faculty of Education and Psychology where the entire scientific program is held.

Address: **Budapest, Kazinczy utca 23–27.**

The venue of the reception on Thursday is the main building of the Eötvös Loránd University (**Aula Magna**).

Address: **Budapest, Egyetem tér 1–3.**

The gala dinner on Friday is held in the Izabella building (**IZU**) of the Faculty of Education and Psychology.

Address: **Budapest, Izabella utca 46.**

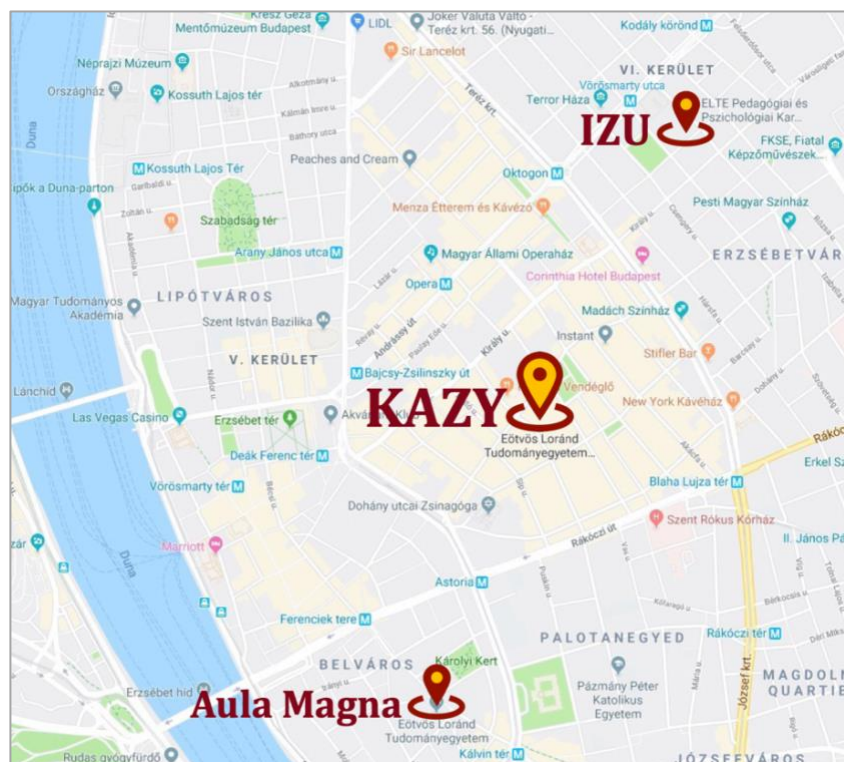

CONFERENCE INFORMATION DESK

The information desk (i) will be located on the 2nd floor of the Kazinczy building (See the map on page 6).

Information boards will be displayed at the main conference venue (Kazinczy building 2nd and 3rd floors)

- ⇒ Changes in the program
- ⇒ Floor plans
- ⇒ Further important information

For urgent information and immediate assistance, please contact the secretary of the conference:

Dr. Attila Rausch
Tel.: +36 30 3327811
E-mail: rausch.attila@ppk.elte.hu

CONFERENCE SUPPORT

Should you need any assistance during the conference, contact any member of the support team, who will be wearing dark red conference branded T-shirts.

LUNCH BREAKS

Lunch will be served on the 3rd floor of the Kazinczy building. Vegetarian and gluten free options are also available. Ask members of the support team, if you need assistance.

COFFEE BREAKS

Coffee, tea, and other beverages will be served on the 3rd floor of the Kazinczy building during coffee breaks which are indicated on the Time Table. Coffee and water will be available at all times.

CONFERENCE BADGES

Participants receive a name badge which they are kindly requested to wear during the conference to have access to the booked conference activities.

Kazinczy building (KAZY)

ELTE Eötvös Loránd University Faculty of Education and Psychology

2nd Floor

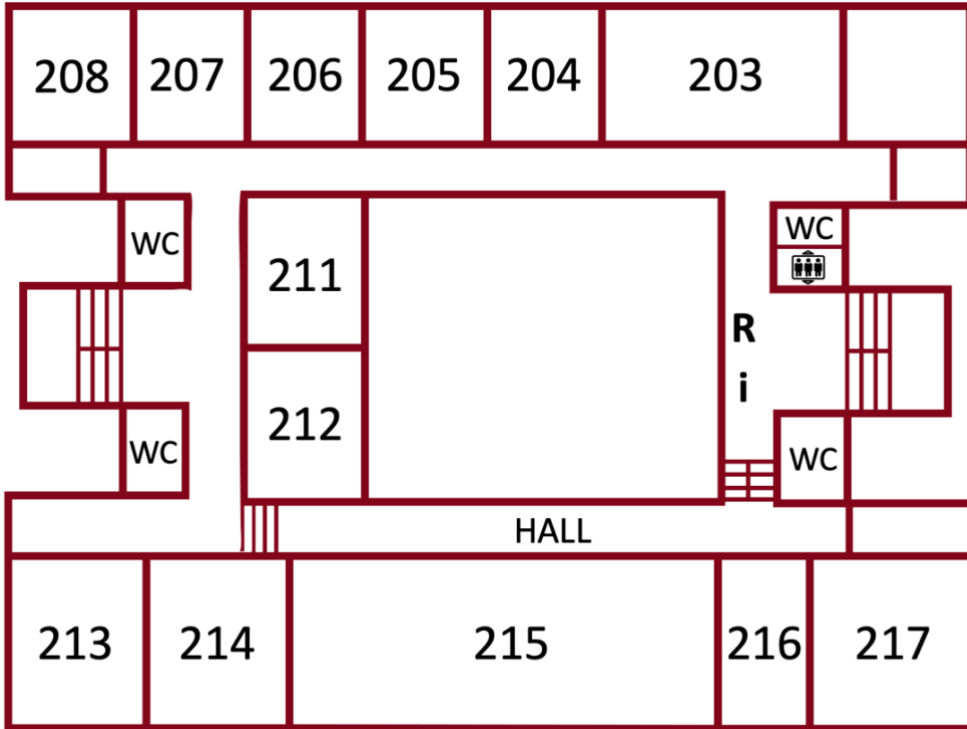

R = Registration, i = Information desk

3rd Floor

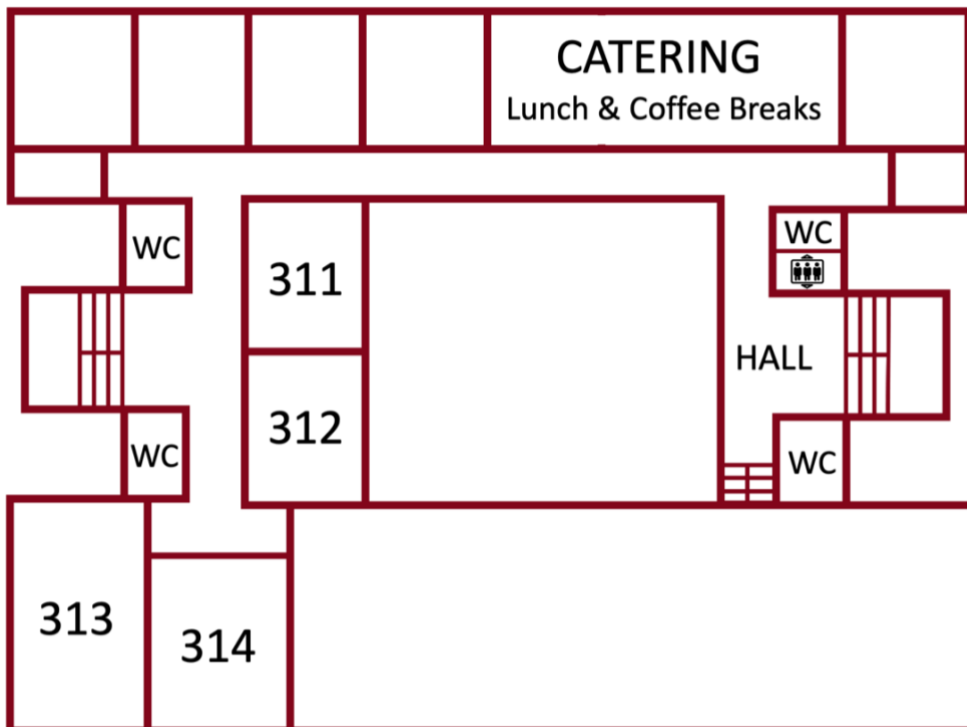

August 29, 2019 (Thursday)

10.30–11.00 Conference opening (215)

11.00–12.00 **PLENARY 1** (215)

Maurice J. Elias

Building a worldwide capacity to promote SEL: The academy for SEL in schools

Chair: Anikó Zsolnai

12.00–13.00 Lunch (3rd floor)

13.00–14.30 CP01–CP03, SY01, WS01–WS03 Session

<p>CP01</p>	<p>Student-teacher relationships and teachers' perceptions <i>Chair: Anikó Fehérvári</i></p> <ul style="list-style-type: none"> • Teachers' perceptions regarding shy students and implications for socio-emotional interventions <i>Anat Korem</i> • Teacher-student relationships in adolescence: Result of a pilot study <i>Lilla Szabó, Attila Rausch, Anikó Zsolnai</i> • Well-being, academic emotions and learning competence: A mixed method study in undergraduate students <i>Hannelore Reicher, Marlies Matischek-Jauk</i> • Convincing the Unconvinced: SEL advocacy in a complex age <i>Faye Hobson</i> 	<p>204</p>
<p>CP02</p>	<p>Health and well-being in the digital age <i>Chair: Annalisa Morganti</i></p> <ul style="list-style-type: none"> • ICT based sociometrical assessment of integrating preschool communities <i>Endre Horváth, Erika Herbainé Szekeres, Ágota Szekeres</i> • Index for social emotional technologies: Challenging approaches to inclusive education <i>Annalisa Morganti, Stefano Pascoletti, Alessia Signorelli</i> • Well-being of children and the dynamics of the digital age <i>Anca Georgiana Simion, Cristian Stan</i> • Does satisfaction of the basic need for autonomy influence curiosity? <i>Nicola Schutte</i> 	<p>205</p>

13.00–14.30

<p>CP03</p>	<p>Resilience and school <i>Chair: Birgitta Kimber</i></p> <ul style="list-style-type: none"> • Resilience in schoolchildren: Cross-cultural perspective <i>Renata Miljević-Riđički, Celeste Simões, Birgitta Kimber</i> • School as resilience tutor: A didactic path in Italy and Spain <i>Sara Gabrielli, Cesare Fregola</i> • Personal effectiveness as the real benefit of the learnable emotional intelligence: A new perspective in teacher training <i>Alina Turculet</i> • Students' Motivation in Higher Education – Conclusions of a Survey <i>Nárcisz Kulcsár, Zsuzsanna Tóth</i> 	<p>206</p>
<p>SY01</p>	<p>'Learning to live and living to learn: Emotion Coaching, a novel relational approach to supporting educational relationships and sustainable staff well-being' <i>Chair: Licette Gus</i> <i>Discussants: Louise Gilbert, Janet Rose</i></p> <ul style="list-style-type: none"> • Introducing the evidence-base for Emotion Coaching in UK educational settings <i>Janet Rose</i> • A way of being and a way of becoming: The EC model of setting engagement and professional practice <i>Catherine Louise Gilbert</i> • Developing practitioners' professional confidence and emotion socialisation skills through the use of Emotion Coaching <i>Licette Gus</i> 	<p>215</p>
<p>WS01</p>	<p>Teaching skills for success through SEL <i>Ed Dunkelblau</i></p>	<p>217</p>
<p>WS02</p>	<p>Target Teaching <i>Kelli Dillingham Parcher, Shannon Burns</i></p>	<p>203</p>
<p>WS03</p>	<p>“Together we are trying to create a small community, a self-sustaining community”: Supportive environment for people with psychosocial disabilities <i>Andrea Perlusz, Borbála Bánya, Lucia Csabai, Zsófia Pichler, Csilla Cserti-Szauer, Péter Juhász</i></p>	<p>213</p>

14.30–15.00 Coffee Break (3rd floor)

15.00–16.30

<p>CP06</p>	<p>Predictors of well-being in adolescence <i>Chair: Marta Fulop</i></p> <ul style="list-style-type: none"> • School competitive climate and students' psychological and somatic well-being <i>Marta Fulop, Balazs Varga, Nóra Sebestyén</i> • Factors predicting emotional problems in upper secondary school <i>Jan Arvid Haugan, Per Frostad, Per Egil Mjaavatn</i> • Predictors of family satisfaction of youth at risk in Croatia <i>Ivana Maurović, Gabrijela Ratkajec Gašević, Anja Mirosavljević, Antonija Žižak</i> 	<p>206</p>
<p>SY02</p>	<p>Social problem-solving among children, adolescents, and university students: Results of Hungarian cross-sectional, longitudinal, and comparative investigations <i>Chair: László Kasik</i></p> <ul style="list-style-type: none"> • Development of social problem-solving among adolescents: Hungarian cross-sectional and longitudinal studies <i>László Kasik, Zita Gál</i> • The role of environmental factors in the development of social problem-solving: Differences between disadvantaged and non-disadvantaged adolescents <i>József Balázs Fejes, Éva D. Molnár</i> • Characteristics of negative problem orientation: Hungarian investigations with questionnaire, story, and EEG <i>László Kasik, Zita Gál, Péter Csibri</i> • The relationship between social problem solving, life satisfaction and school well-being among adolescents and university students <i>Szilvia Jámbori, Zita Gál, József Balázs Fejes</i> 	<p>215</p>
<p>WS04</p>	<p>Monitoring social relations in real-time <i>Anna Szekely, Bianka Gonye, Aditi Gandotra, Eniko Kasos, Eszter Kotyuk, Peter Haga, Tamas Borsos, Zsolt Kenesi, Mate Szebenyi, Andras Veres</i></p>	<p>217</p>
<p>WS05</p>	<p>RESCUR Surfing the Waves A resilience programme for school children <i>Carmel Cefai</i></p>	<p>203</p>

15.00–16.30

WS06	What is the World is Family TIES? (A family centred intervention to support the transfer of Social Emotional Competency from the learning environment to the real-world environment of the home) <i>Robert Calame, Karina Svejgaard Vase, Dennis Thomsen</i>	213
WS07	Characteristics and experiences of nurture group and Learning Support Zone educators in Malta <i>Maria Pace</i>	211

16.30–17.00 Coffee Break (3rd floor)

17.00–18.30 CP07–CP10, WS08–WS11 Session

CP07	<p>Social and emotional learning programs and promoting resilience from kindergarten to secondary school <i>Chair: Renata Miljević-Riđički</i></p> <ul style="list-style-type: none"> • Sport's program in Kindergarten Prečko: A path to well-being <i>Kosjenka Lovrec-Marinović, Mirjana Celić, Romana Špacapan, Danijela Bencuz, Vlatka Novak</i> • Resilience promotion in schools through RESCUR Curriculum: The RESCUR in Action Project <i>Celeste Simões, Paula Lebre, Anabela Caetano, Team RESCUR</i> • MAPLE: A social and emotional learning program for preschoolers in Taiwan <i>Huei-Tsyrr Chen, Li-Jung Yang, I-Ching Lee, Chiu-Kuei Ko</i> • Learning to Be: promoting Social and Emotional learning through relationship-centred learning environment and teaching methods <i>Marco Ferreira, Sanela Talić, Baiba Martinsone</i> 	204
CP08	<p>SEL implementations <i>Chair: Neil Humphrey</i></p> <ul style="list-style-type: none"> • SEL 'production line' and tailor-made interventions: Obstacles of implementation <i>Eliezer Yariv, Daniel Sperling</i> • RESCUR (resilience curriculum) Sweden: An implementation study <i>Therése Skoog, Birgitta Kimber, Josefine Lilja, Barbro Henriksson, Charli Eriksson</i> • PORCOSPINI: Empowering children, families and teachers against child abuse and neglect with a SEL process <i>Rocco Briganti</i> • CACE cracked: Social and emotional learning provides PATHS to improved quality of life <i>Neil Humphrey, Margarita Panayiotou, Alexandra Hennessey</i> 	205

17.00–18.30

CP09	<p>Socio-emotional skills, well-being and social support <i>Chair: Carmel Cefai</i></p> <ul style="list-style-type: none"> • The Mutual appreciative model for social and emotional well-being <i>Claudia Koby</i> • The influence of social support and community in the development of school well-being <i>Krisztina Nagy</i> • The subjective wellbeing of children with a migrant background in Malta <i>Carmel Cefai, Noemi Tari Keresztes, Natalie Galea, Rachel Spiteri</i> • The role of socio-emotional skills in predicting internalized problems <i>Miranda Novak, Martina Ferić, Josipa Mihić, Valentina Kranželić</i> 	206
CP10	<p>Resilience and stress among young children <i>Chair: Anna Szekely</i></p> <ul style="list-style-type: none"> • The Use of theraplay informed activities to improve relationships and reduce stress in children <i>Sue Salisbury</i> • Elements of successful adaptation to survive in a challenging environment <i>Anna Szekely</i> • Objective measurement of movement to identify at risk populations at different ages <i>Eszter Kotyuk, Aditi Gandotra, Bianka Gonye</i> 	215
WS08	<p>Problem solving training: A protective factor in developing resilience <i>Kimberlee Parker, John Choi, Robert Calame</i></p>	217
WS09	<p>Wellbeing education in secondary schools: Building it in, rather than bolting it on <i>Eleni Vardaki</i></p>	203
WS10	<p>Growing resilience through role playing and spontaneity <i>Marius Valentin Luca, Andreea Alexandrescu</i></p>	211
WS11	<p>Emotion Coaching: A universal strategy for supporting and promoting sustainable emotional well-being <i>Licette Gus, Louise Gilbert, Janet Rose</i></p>	213

19.30–22.00 Reception (Aula Magna – See page 4)

10.30–12.00

<p>CP12</p>	<p>Promoting well-being and resilience in schools <i>Chair: Adina Colomeischi</i></p> <ul style="list-style-type: none"> • Secondary school nurture groups: Models that work <i>David Colley</i> • Resilience of Romanian children with migrant parents <i>Adina Colomeischi</i> • The VIP-Partnership Program in Norwegian schools: An assessment of intervention effects <i>Astrid Hoås Morin</i> • Future orientation: Associations with student’s perception of social support and resilience. <i>Per Frostad, Per Egil Mjaavatn</i> 	<p>205</p>
<p>CP13</p>	<p>Social and emotional development in kindergarten <i>Chair: László Kasik</i></p> <ul style="list-style-type: none"> • Creating an environment that promotes socio-emotional development of preschool children <i>Ljiljana Petrinc, Dijana Andrašek</i> • Fostering prosocial behavior with tale-based program in Hungarian kindergartens <i>Szilvia Hegedűs</i> • Social and emotional development: Practice in kindergarten, Zagreb <i>Vesna Glavović, Mirela Marjanac, Marina Vuko</i> • Arts promoting resilience: The Rescur in Action experience <i>Paula Lebre, Simões Celeste, Santos Anabela</i> 	<p>206</p>
<p>SY03</p>	<p>Mindfulness from a psychophysiological standpoint <i>Chair: Vekety Boglarka</i></p> <ul style="list-style-type: none"> • Electrodermal activity and factors of mindfulness <i>Krisztian Kasos, Luca Csirmaz, Szabolcs Zimonyi, Eniko Kasos, Eszter Kotyuk, Anna Szekely</i> • Association of adults’ trait mindfulness, EDA and EEG oscillations <i>Vekety Boglarka, Alexander H.N. Logemann, Zsofia K. Takacs</i> • Can preschoolers really meditate? <i>Adam Koncz, Reka Kassai, Zsolt Demetrovics, Zsofia K. Takacs</i> 	<p>215</p>

10.30–12.00

WS12	Team building with Aggression Replacement Training: How to use values in team management <i>Cecylia Bieganowska</i>	217
WS13	Centrality of relationships to children's social-emotional well-being at school <i>Chad W. Kordt-Thomas</i>	203
WS14	How can we increase the effect of SEL programs by emphasizing factors that contribute to wellbeing, relationship, and increased self-efficacy? <i>Knut Gundersen</i>	211
WS15	Developmental relationship building: An active ingredient in Social Emotional Learning <i>Robert Calame, Kimberlee Parker</i>	213

12.00–13.00 Lunch (3rd floor)

13.00–14.00 Poster session (Hall – 2nd floor)

PS	<ul style="list-style-type: none"> • How do students perceive study-related emotions? <i>Marlies Matischek-Jauk, Hannelore Reicher</i> • Exploring mental health in schools among adolescents in Italy <i>Valeria Cavioni, Alessia Agliati, Ilaria Grazzani</i> • Differential SEL effect for children with diverse initial states: II. The Communication-Skill Curriculum designed by Taiwan Happiness Village Association <i>Che Cheng, Keng-Ling Lay, Chen-Yu Lin, Yingying Li, Tai-Chuan Chang, Li-Jung Yang, Huei-Tsyrr Chen, Yuan-Jung Wang</i> • Emotion regulation aspects of non-suicidal self-injury in a juvenile penitentiary context <i>Melinda Reinhardt, Zsolt Horváth, Blanka Márton, Boglárka Drubina, Gyöngyi Kökönyei</i> • Family support and somatic complaints in adolescents: Mediating effect of rumination <i>Ágota Örkényi, Zsolt Horváth, Melinda Reinhardt, Gyöngyi Kökönyei</i> • Differential SEL effect for Children with Diverse Initial States: I. The Self-Concept Curriculum designed by Taiwan Happiness Village Association <i>Yingying Li, Keng-Ling Lay, Chen-Yu Lin, Tai-Chuan Chang, Li-Jung Yang, Huei-Tsyrr Chen, Yuan-Jung Wang</i> 	Hall (2nd floor)
-----------	---	------------------

13.00–14.00

<p>PS</p>	<ul style="list-style-type: none"> • When a SEL Program is implemented without community partnership: Differential SEL effect for children with diverse social economic status <i>Chen-Yu Lin, Keng-Ling Lay, Yingying Li, Li-Jung Yang, Huei-Tsy Chen</i> • Resilience and burnout in teaching profession <i>Adina Colomeischi, Tudor Colomeischi</i> • The PREPARE Curriculum: Programs for prevention and intervention <i>Kimberlee Parker, Kelli Parcher, Johannes Finne</i> • The mediating role of parent-child relationships in the association between early life stress and emotional and behavioural outcomes <i>Lorraine Swords, Trevor Spratt</i> • The Second Step Program: The effectiveness research in the Czech Republic <i>Kateřina Palová, Eleonora Smékalová</i> • Lecturers` well-being in the academic organization: Research results from the past years <i>Erzsébet Mária Jármai</i> • Being in the Zone: Comparing the Phenomenology of Consciousness during Sport and Hypnosis <i>Eniko Kasos, Krisztian Kasos, Emese Józsa, Katalin Varga, Anna Szekely, Szabolcs Zimonyi, Attila Szabó</i> • Psychophysiological correlates of state and trait anxiety <i>Luca Csirmaz, Anna Szekely, Krisztian Kasos</i> • Electrodermal fingerprint - task specificity <i>Szabolcs Zimonyi, Bianka Gonye, Krisztian Kasos, Eszter Kotyuk, Anna Szekely</i> • Flow proneness and electrodermal activity <i>Helga Stadler, Szabolcs Zimonyi, Krisztian Kasos, Anna Szekely, Eszter Kotyuk</i> • A novel approach to use fundament movement skills amongst preschoolers <i>Aditi Gandotra, Eszter Kotyuk, Renata Cserjesi</i> • Social relation formation speed and electrodermal activity <i>Bianka Gonye, Eniko Kasos, Eszter Kotyuk, Anna Szekely</i> 	<p>Hall (2nd floor)</p>
-----------	---	-------------------------

14.00–15.00 *ENSEC members' meeting* (215)

15.00–19.00 *Cultural activities* (Different locations – See the information board)

20.00–23.00 *Gala Dinner* (Izabella Garden – IZU – See page 4)

10.20–11.50

<p>CP15</p>	<p>Early childhood education and social-emotional learning <i>Chair: Éva D. Molnár</i></p> <ul style="list-style-type: none"> • Preschool children’s reaction on peer distress: Perspectives from parents and teachers <i>Szilvia Hegedűs</i> • Teachers’ perceptions of their own emotions, coping strategies with students’ emotions, and students’ school adjustment. <i>Maria Poulou</i> • Social-emotional skills in early education <i>Monica Coste</i> • Benefits of the program “Growing together plus” <i>Minja Jeic</i> 	<p>205</p>
<p>WS16</p>	<p>MetaEmotions at school: A training program for "emotionally inclusive" schools <i>Antonella D'Amico</i></p>	<p>203</p>
<p>WS17</p>	<p>Social skills training at schools in disadvantaged areas in Denmark <i>Bo Ertmann</i></p>	<p>217</p>
<p>WS18</p>	<p>Real-time monitoring of arousal: Obimon <i>Krisztian Kasos, Szabolcs Zimonyi, Luca Csirmaz, Andras Veres, Anna Szekely</i></p>	<p>211</p>
<p>WS19</p>	<p>Z Generation in digital age: How to use social emotional competencies to prevent cyberbullying <i>Cecylia Bieganowska</i></p>	<p>213</p>
<p>WS20</p>	<p>From talking common sense to Skillsstreaming <i>Tiina Röning</i></p>	<p>206</p>

11.50–12.00 Short Break (3rd floor)

NOTES



12.00–13.30 CP16, WS20–WS24 Session

CP16	<p>Teachers, SEL, and bullying <i>Chair: József Balázs Fejes</i></p> <ul style="list-style-type: none"> • Social and emotional competence and bullying victimization of pupils with and without intellectual disability <i>Anamarija Žic Ralić, Natalija Lisak, Snježana Sekušak-Galešev, Ljiljana Pintarić Mlinar</i> • Does an SEL program have similar impacts on students involved in different bully-roles? <i>Vitor Alexandre Coelho, Vanda Sousa, Marta Marchante, Patrícia Brás, Ana Maria Romão</i> • Teachers as targets of bullying: a social media study <i>Nita Corene De Wet</i> • The role of emotions in teachers' professional identity <i>Maria Mesterhazy</i> 	204
WS21	<p>FuelBox: Conversations that entertain, develop and strengthen people and their relationships <i>Thomas Zandstra Helmsgård, Morten Sigurdson, Vegard Viestad</i></p>	203
WS22	<p>How aligning our beliefs can unleash truly effective social and emotional learning <i>Daniel Johnston, Manuela Bolton</i></p>	217
WS23	<p>Social-emotional supports for the Caretaker <i>Eddie Beaucage</i></p>	211
WS24	<p>Techniques of expressing emotions in kindergarten and primary school <i>Ecaterina Maria Unianu</i></p>	213

13.30–15.00 Lunch and conference closing (3rd floor)

NOTES



List of Participants

NAME	ORGANISATION	COUNTRY	SESSION
Didem Aksoy	Education Specialist	Turkey	
Laura Andreea Alexandrescu	Verita International School, Bucharest, Romania	Romania	WS10
Dijana Andrašek	Kindergarten	Croatia	CP13
Anett Bakos		Hungary	
Borbála Bányai	ELTE Eötvös Loránd University	Hungary	WS03
Eddie Beaucage	Athletex	Canada	WS23
Enikő Orsolya Bereczki	ELTE Eötvös Loránd University	Hungary	
Līga Berzina	Mācību centrs Atbalsts	Latvia	
Cecylia Bieganowska	TODO Concept	Poland	WS12, WS19
Rocco Briganti	Specchio Magico cooperativa sociale onlus	Italy	CP08
Shannon Burns	Center for Anti-Bullying and Non-Violence	United States	
Lena Haller Buseth	NTNU Norway	Norway	CP06
Robert Calame	WOLF Social Competencies Inc.	Canada	WS06, WS08, WS15
Valeria Cavioni	University of Milano - Bicocca	Italy	PL02, CP11, PS, CP14
Carmel Cefai	Carmel Cefai	Malta	CP09, WS05
Mirjana Celić	Home	Croatia	CP07
Chen-Chuan Chang	Huajiang Elementary school	Taiwan	
Huei-Tsyrr Chen	Caremind Cultural and Educational Institution	Taiwan	CP07, PS
Chienjung Chen	Taipei City Government	Taiwan	
Che Cheng	Naional Taiwan University	Taiwan	PS
Vitor Alexandre Coelho	Académico de Torres Vedras	Portugal	CP14, CP16
David Colley	Oxford Brookes University	United Kingdom	CP12
Adina Colomeischi	Universitatea Stefan cel Mare	Romania	CP12, PS
Monica Coste	Babes-Bolyai University	Romania	CP15
Helen Cowie	University of Surrey	United Kingdom	PL03

List of Participants

NAME	ORGANISATION	COUNTRY	SESSION
Davorka Crnkovic	Kindergarten Vrbik	Croatia	
Lucia Csabai	ELTE Eötvös Loránd University	Hungary	WS03
Kinga Csányi	ELTE Eötvös Loránd University	Hungary	
Csilla Cserti-Szauer	Eötvös Loránd University Bárczi Gusztáv Faculty of Special Needs Education	Hungary	WS03
Éva D. Molnár	University of Szeged	Hungary	SY02, CP15
Antonella D'amico	Università Degli Studi Di Palermo	Italy	WS16
Lamia Dada	DADA ENTERPRISE	Lebanon	
Nita Corene De Wet	University of the Free State	South Africa	CP16
Isabel De Wet	Department of Education	South Africa	
Zsolt Demetrovics	ELTE Eötvös Loránd University	Hungary	
Kelli Dillingham Parcher	Center for Anti-Bullying and Non-Violence	United States	PS, WS02
Niva Dolev	Kinneret Academic College	Israel	CP05
Ed Dunkelblau	Academy for SEL in Schools	United States	WS01
Efrat Dvir	Idc	Israel	
Maurice J. Elias	Rutgers University	United States	PL01
Ebru Ersay	Gazi University	Turkey	
Bo Vallø Ertmann	University College Copenhagen	Denmark	WS17
Anikó Fehérvári	ELTE Eötvös Loránd University	Hungary	CP01
József Balázs Fejes	University of Szeged	Hungary	SY02, CP16
Eunice De Jesus Ferreira Leite Fernandes Freitas	Faculdade de Motricidade Humana, Lisbon, Portugal	Portugal	CP14
Per Frostad	Norwegian University of Science and Technology	Norway	CP06, CP12
Marta Fulop	Institute of Cognitive Neuroscience and Psychology, Hungarian Academy of Sciences	Hungary	CP06
Sara Gabrielli	Sapienza Università di Roma	Italy	CP03
Zita Gál	University of Szeged	Hungary	SY02
Justin Gerada	Teacher	Malta	

List of Participants

NAME	ORGANISATION	COUNTRY	SESSION
Catherine Louise Gilbert	Emotion Coaching UK	United Kingdom	SY01, WS11
Vesna Glavovic	DV SOPOT	Croatia	CP13
Ilaria Grazzani	University of Milano-Bicocca	Italy	PL02, CP11, PS
Knut Gundersen	Vid Pedagogical University College	Norway	WS14
Licette Gus	Emotion Coaching UK	United Kingdom	SY01, WS11
Jan Arvid Haugan	Norwegian University of Science and Technology	Norway	CP06
Szilvia Hegedűs	University of Szeged	Hungary	CP13, CP15
Thomas Zandstra Helmsgård	Smart Kompetanse AS	Norway	WS20
Ramona Henter	Transilvania University of Brasov	Romania	CP04
Mária Hercz	ELTE Eötvös Loránd University	Hungary	CP04
Faye Hobson	Salzburg Global Seminar	Austria	CP01
Endre Horváth	ELTE Eötvös Loránd University	Hungary	CP02
Wei-Hsun Hsu	Taipei City Government, Taiwan	Taiwan	
Jean Hughes	Dalhousie University	Canada	
Neil Humphrey	University of Manchester	United Kingdom	CP08, CP14
Szilvia Jámboři	University of Szeged	Hungary	SY02
Erzsébet Mária Jármai	Budapest Business School University of Applied Sciences	Hungary	PS
Minja Jeic	Kindergarten Vrbik	Croatia	CP15
Stephen Jennings	Cardiff University	United Kingdom	CP14
Richard Joannides	Verita International School, Bucharest, Romania	Romania	
Daniel Johnston	GEMS World Academy Switzerland	Switzerland	WS22
Péter Juhász	Semmelweis University Health Services Management Training Centre	Hungary	WS03
László Kasik	University of Szeged	Hungary	SY02, CP13

List of Participants

NAME	ORGANISATION	COUNTRY	SESSION
Krisztian Kasos	ELTE Eötvös Loránd University	Hungary	PS, SY03, WS18
Lynda Margaret Kay	University of Gloucestershire	United Kingdom	CP11
Birgitta Kimber	Umea University	Sweden	CP03, CP08
Claudia Koby	Krembo Wings A Youth Movement for Children with and without Disabilities	Israel	CP09
Adam Koncz	ELTE Eötvös Loránd University	Hungary	SY03
Daphne Kopelman-Rubin	IDC	Israel	
Chad W. Kordt-Thomas	Smith College	United States	WS13
Anat Korem	The Hebrew University of Jerusalem, educational-counseling division; Levinsky College of Education, Tel Aviv, Israel.	Israel	CP01, CP05
Eszter Kotyuk	MTA-ELTE Lendület Adaptation Research Group, ELTE Eötvös Loránd University, Hungary	Hungary	CP10
Adrienn Král	Eötvös Loránd University Faculty of Science	Hungary	CP04
Zane Kronberga	Autism Centre	Latvia	
Csilla Lazsádi	Babeş-Bolyai University	Romania	CP04
Paula Lebre	Faculdade de Motricidade Human	Portugal	CP13
Gili Leibushor	Mandel School For Educational Leadership	Israel	
Yingying Li	National Taiwan University	Taiwan	PS
Chih Ann Li	Taipei Lanya Junior High School	Taiwan	
Chen-Yu Lin	National Taiwan University	Taiwan	PS
Mei-Lin Lin	Taipei Mandarin Experimental Elementary School	Taiwan	
Yating Lin	Chengde Elementary School	Taiwan	
Kosjenka Lovrec-Marinović	Dječji vrtić Prečko	Croatia	CP07

List of Participants

NAME	ORGANISATION	COUNTRY	SESSION
Ajana Löw	University of Zagreb, Faculty of Education and Rehabilitation Sciences	Croatia	CP05
Marius Valentin Luca	Verita International School, Bucharest, Romania	Romania	WS10
Mirela Marjanac	DV SOPOT	Croatia	CP13
Marlies Matischek-Jauk	University College of Teacher Education Styria	Austria	CP01, PS
Ivana Maurović	Faculty of Education and Rehabilitation Sciences	Croatia	CP06
Maria Mesterhazy	ELTE Eötvös Loránd University	Hungary	CP16
Tristan Middleton	University of Gloucestershire	United Kingdom	CP11
Josipa Mihic	University of Zagreb	United States	CP04
Renata Miljević-Ridički	University of Zagreb	Croatia	CP03, CP07
Per Egil Mjaavatn	Norwegian University of Science and Technology	Norway	CP12
Annalisa Morganti	University of Perugia	Italy	CP02
Astrid Hoås Morin	Norwegian University of Science and Technology (NTNU)	Norway	CP12
Krisztina Nagy	University of Szeged	Hungary	CP09
Lene Nørgaard	CBF Herning kommune	Denmark	
Miranda Novak	Faculty of Education and Rehabilitation Sciences, University of Zagreb	Croatia	CP09
Attila Oláh	ELTE Eötvös Loránd University	Hungary	
Ágota Örkényi	Institute of Psychology, ELTE Eötvös Loránd University	Hungary	PS
Maria Pace	National School Support Services	Malta	WS07
Kateřina Palová	Palacký University Olomouc	Czech Republic	PS
Kimberlee Parker	WOLF Social Competencies	Canada	PS, WS08, WS15
Stefano Pascoletti	Università di Udine / Italy	Italy	CP02

List of Participants

NAME	ORGANISATION	COUNTRY	SESSION
Andrea Perlusz	Eötvös Loránd University Bárczi Gusztáv Faculty of Special Education	Hungary	
Ljiljana Petrinc	Kindergarten	Croatia	
Zsófia Pichler	ELTE Bárczi Gusztáv Faculty of Special Education	Hungary	WS03
Maria Poulou	University of Patras	Greece	CP15
Attila Rausch	ELTE Eötvös Loránd University	Hungary	CP01
Hannelore Reicher	University Graz	Austria	CP01, PS
Melinda Reinhardt	ELTE Eötvös Loránd University	Hungary	PS
Lin Richard	NCCU	Taiwan	
Janet Rose	Norland College	United Kingdom	SY01, WS11
Tiina Röning	Finnish ART association	Finland	WS20
Florence Ruby	Nurtureuk	United Kingdom	CP11
Sue Salisbury	Central Bedfordshire Council	United Kingdom	CP10
Mónika Sándor	ELTE Eötvös Loránd University	Hungary	CP04
Anabela Caetano Santos	Lisbon University	Portugal	CP05, CP07, CP13
Nicola Schutte	University of New England	Australia	CP02
Yu-Hsu Shih	Taipei Municipal Xin Min Junior High School	Taiwan	
Chun Ming Shih	Taipei Xishan Experimental Elementary School	Taiwan	
Alessia Signorelli	Università degli Studi di Perugia	Italy	CP02
Morten Sigurdson	Smart Kompetanse	Norway	WS21
Anca Simion	Babes-Bolyai University	Romania	CP02
Celeste Simões	Faculdade de Motricidade Humana	Portugal	CP03, CP05, CP07, PL03
Therése Skoog	University of Gothenburg	Sweden	CP08
Romana Špacapan	Dječji vrtić Prečko	Croatia	CP07
Lorraine Swords	Trinity College Dublin	Ireland	PS
Lilla Szabó	Eötvös Loránd University	Hungary	CP01

List of Participants

NAME	ORGANISATION	COUNTRY	SESSION
Anna Szekely	ELTE Eötvös Loránd University	Hungary	CP10PS, SY03, WS04, WS18
Ágota Szekeres	ELTE Eötvös Loránd University	Hungary	CP02
Wendy Ann Tabuteau	Partnership for Children	United Kingdom	
Sanela Talić	Institute for research and development Utrip	Slovenia	CP07
Dennis Thomsen	CBF Herning kommune	Denmark	WS06
Zsuzsanna Tóth	Budapest Business School University of Applied Sciences	Hungary	CP03
Alina Turculet	Transilvania University of Brasov, Romania	Romania	CP03
Ecaterina Maria Unianu	Transilvania University of Brasov, Romania	Romania	WS24
Eleni Vardaki	St Catherines British School (Athens, Greece) / Freelance Youth Mentor	Greece	WS09
Karina S. Vase	CBF Herning kommune	Denmark	WS06
Lila Vasilescu	Verita International School of Bucharest	Romania	
Boglárka Vekety	ELTE Eötvös Loránd University	Hungary	SY03
Vegard Viestad	Smart Kompetanse	Norway	WS21
Marina Vuko	DV SOPOT	Croatia	CP13
Eliezer Yariv	Gordon College of Education	Israel	CP08, CP11
Anamarija Žic Ralić	Faculty of Education and Rehabilitation Sciences, University of Zagreb	Croatia	CP05, CP16
Anikó Zsolnai	ELTE Eötvös Loránd University	Hungary	PL01, CP01